

ALTA Installation Instructions

Basic Principles:

- The entire wall area, including gable end walls, must be covered with Alta.
- For proper water shedding install using shingle-lap fashion (upper layers overlapping lower)
- Overlap seams: Minimum of 6" vertical and 2" horizontal

A. Installing the First Course

1. With the roll plumb and starting 2-3 feet from a corner and the bottom edge two inches below the foundation sill plate begin fastening the Alta along a vertical stud location. Printed side facing the exterior.
2. Continue to wrap around the perimeter of the house keeping the bottom edge two inches below the sill plate.
3. Unroll Alta across the wall and rough window openings, ensuring there are no wrinkles in the material.



B. Fasteners and Fastening Frequency

1. Fasten the top of the first course of Alta at every second stud location as it is being rolled out. Do not embed fastener, it should be flush with the surface of Alta.
2. Starting from the middle of a wall and at the top of the material, smooth the Alta removing any wrinkles.
3. Install fasteners vertically every 16 inches until you reach the bottom of the material. Ensure the last row of horizontal fasteners penetrate the wall sheathing or framing member and not the foundation. Plastic-head nails shall be used for wood stud walls, plastic-head screws for steel stud walls and masonry fasteners for CMU walls.
4. Work each way to the end of the wall, always smoothing the material out and starting the fastening at the top and working down.

C. Installing Around Corners

1. For inside corners, install the Alta so that it goes tight into the corner and is at a sharp 90 degree angle. If it is installed so that it is not tight into the corner, it can get cut or ripped when the cladding is installed.
2. Install fasteners on each side of the inside corner
3. For outside corners, wrap the Alta around the corner. Install fasteners on each side of the outside corner.

D. Installing Subsequent Courses

1. If the roll width does not cover the complete height of the wall install the second layer the same as the first and overlapping the course below by at least 2 inches.
2. Install additional courses the same way.
3. Overlap all vertical seams by at least six inches.
4. Run a bead of compatible sealant along top plate of exterior wall. Push the backside of the Alta into the sealant to form a continuous seal at the top of the wall.
5. At the top of the wall use a narrower roll width or precut the Alta to fit the area to be covered. Run a bead of compatible sealant along top plate of exterior wall. Push the backside of the Alta into the sealant to form a continuous seal at the top of the wall. Alternately, the top edge of the Alta can be aligned to the soffit and embedded in sealant as above, letting the bottom of the roll overlap the Alta below it.
6. For gable ends, choose a roll width that would cover the exposed area. Run a bead of sealant at the top of the wall at the roof line, embed the Alta into the sealant and trim off any excess material.
7. After the Alta is completely installed and properly fastened, install a manufacturer approved tape on all seams both horizontal and vertical.

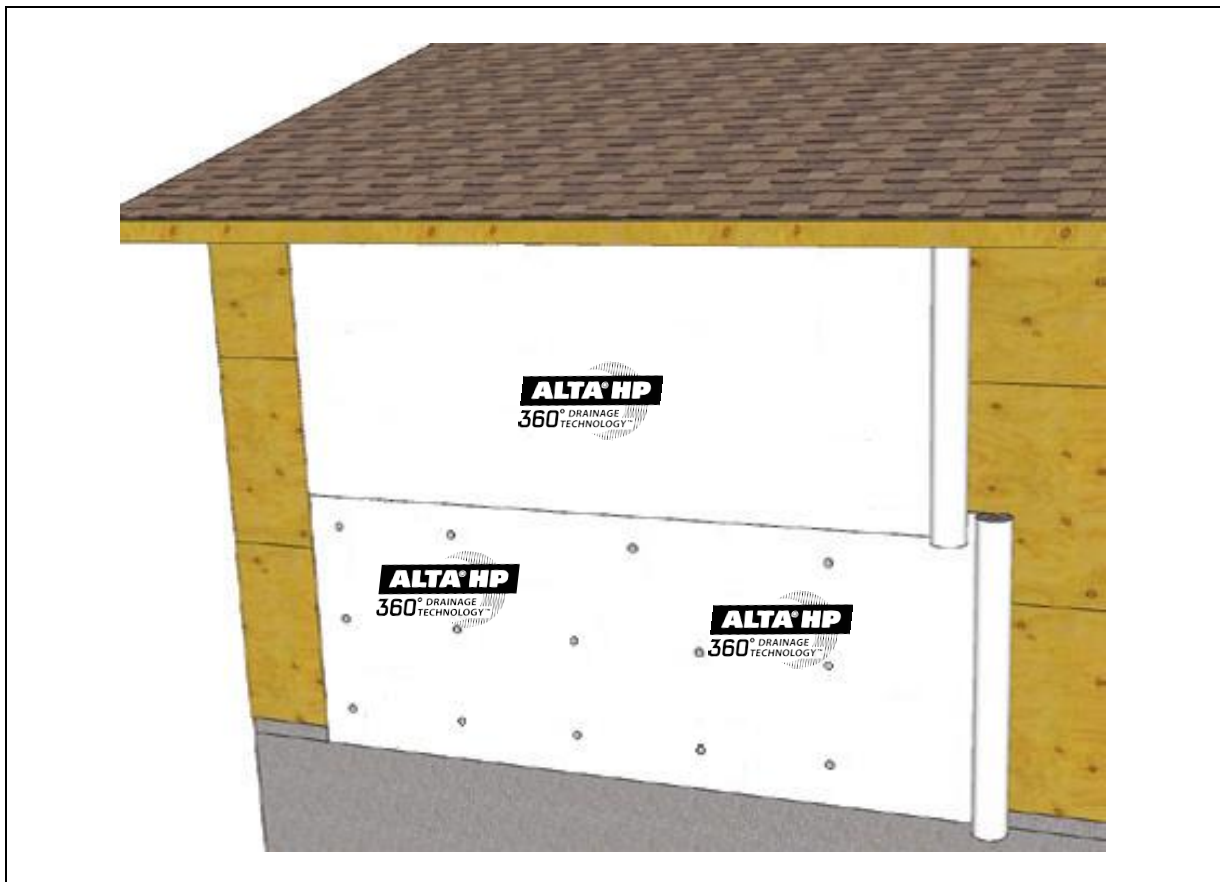

E. Penetrations

1. Window Openings

- a) Before windows are installed, make an inverted Y cut in the wrap at the window rough opening. Wrap excess material into the rough opening at the jambs and sill and fasten to the interior. Make outward diagonal cuts in the wrap at the top corners of the rough opening to form a flap at the head of the opening.

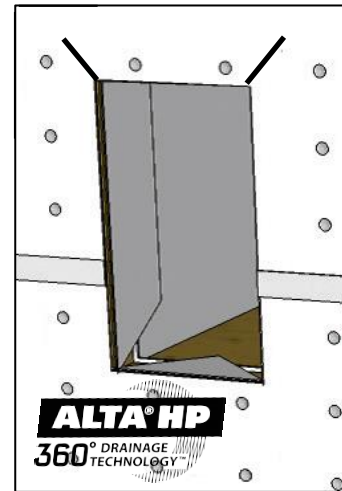
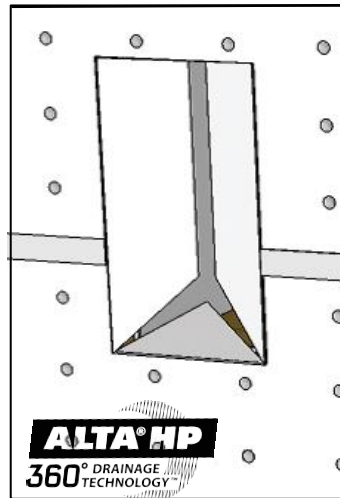

- b) Lift the flap and temporarily tape it in place while the window is installed. Install self-adhered flashing or a sill pan at the sill per the flashing manufacturer's installation instructions.

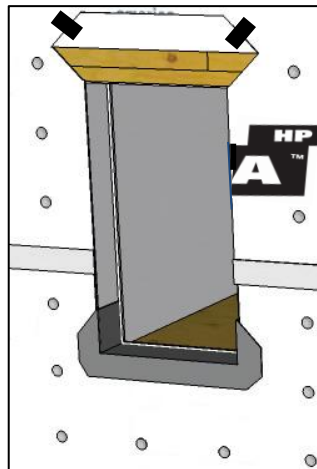

- c) After the windows are installed, cut the excess header flap material so that 1/2" of the window flange is exposed. Install a manufacturer's tape or self-adhered flashing over the bottom edge of the header flap adhering it to the flange. Also apply a manufacturer approved tape or flashing to the cuts made to form the header flap.

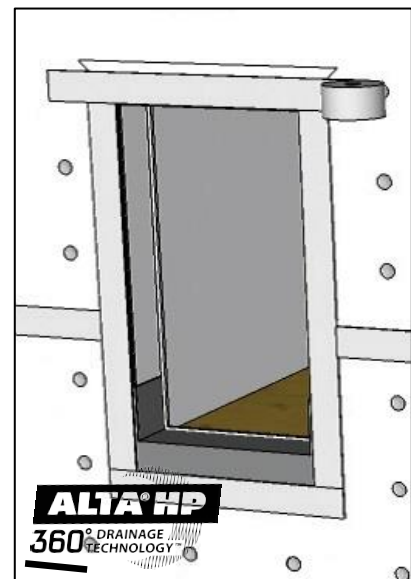
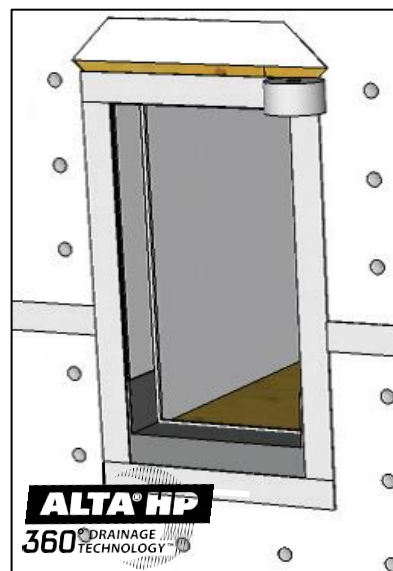

2. Small Pipe Penetrations

- a) Fold back the Alta above and below the penetration to expose the sheathing.
- b) Apply a 3/8" continuous bead of approved sealant around the perimeter of the penetration. Ensure that the bead is in contact with both the Alta and the penetration at all times.
- c) Push the Alta firmly into the bead of sealant.

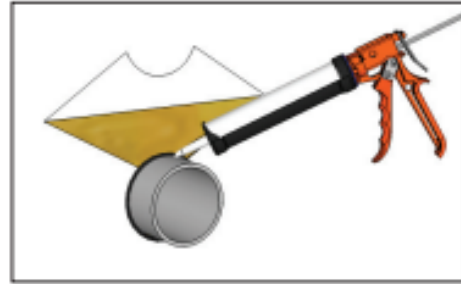

3. Large Pipe Penetrations

- a) If the penetration extends more than six inches from the wall face, terminate the end of the Alta at least 18 inches past the penetration.
- b) Apply sheathing tape or self-adhered flashing over the horizontal cut previously made from the penetration to the edge of Alta.
- c) Continue installing the roll over the Alta that is wrapped around the penetration and sealed to the wall substrate.
- d. Push the Alta firmly in place around a penetration and fasten it every six inches around the penetration taking care to have no fasteners directly above the penetration.

